

AR SHUTTLE

SEMI-AUTOMATED
SOLUTION FOR HIGH-DENSITY
PALLET STORAGE



AR SHUTTLE

A SEMI-AUTOMATED SOLUTION FOR
HIGH-DENSITY PALLET STORAGE



AR SHUTTLE is a compact semi-automated pallet storage solution using self-powered shuttle carts which operate independently to move the pallets in the rack.

Main advantages include:

The AR SHUTTLE system enables you to maximize floor space and height available by minimizing the operating aisles needed for trucks.

Since forklift operators do not have to enter the aisles, maximum safety is guaranteed when handling pallets, avoiding collisions in the rack structure. This reduces maintenance costs as well as the number of issues from handling loads.

The AR SHUTTLE system allows for automatic control of inventory by using sensors to count the number of pallets stored. Remote control and

bar codes help better control the stock, drastically decreasing error margins.

With the AR SHUTTLE system, stored pallets can be loaded and unloaded as FIFO or LIFO, even in freezing chambers up to -30°C.

- OPTIMIZATION OF SPACE
- POWERED BY A RECHARGEABLE LITHIUM BATTERY
- RF CONTROLLED
- FIFO / LIFO
- HIGHLY SAFE OPERATION AT LOW MAINTENANCE COST
- FLEXIBLE STORAGE FOR DIFFERENT TYPES OF PALLETS
- CONSTANT HANDLING FLOW



How does it work?

Designed for high-turnover storage, this solution enables automatically loading and retrieving pallets continuously by using a remote controlled system. Unit loads are either placed on the first available location until the rack is fully loaded, or retrieved from their storage locations and moved to the front ready to be picked by a forklift truck, until the rack is fully unloaded.

Operation

- AR SHUTTLE is positioned in the lane required with a fork lift truck. The pallets are stocked one by one by the fork lift truck at the beginning of the lane.
- AR SHUTTLE lifts up the platform and moves it along the channel until it reaches the first free position, where it puts the pallets. Then, it comes back to the beginning of the lane ready for the next drive cycle.
- Before putting the last pallets into the lane, AR SHUTTLE must be removed and put in a new lane.

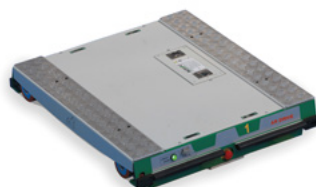

Remote control

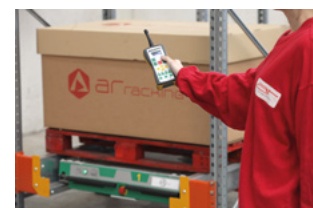

- Each remote control unit can control up to 4 AR SHUTTLEs.
- Pallet count command.
- Onscreen messages for machine maintenance.

AR SHUTTLE is suitable for:

- Warehouses for finished product / semi-finished / raw materials (homogeneous products)
- Buffer for shipping (ready loads)
- Buffer inter-pretational (decoupling between different manufacturing process)
- Buffer for process (Temporary parking of products before their end machining/ finishing)

Discover how our AR SHUTTLE system works in this video:



The pallets can be stored and retrieved according to two different storage orders:

LIFO (Last-in-First-out)

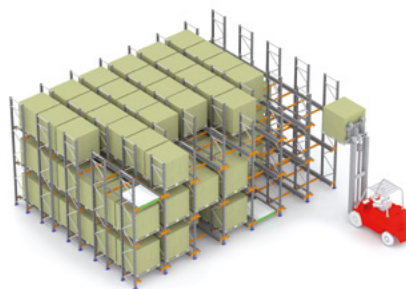

This is the most common system, where the pallets are put in and taken off from the same side.

The lanes should be completely emptied before putting in a new load.

FIFO (First-in-First-out)

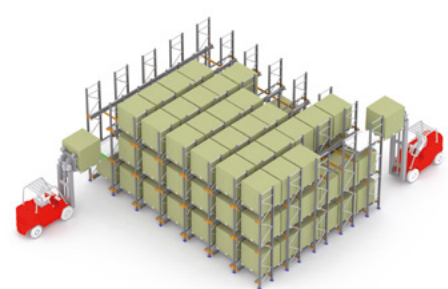

This system is ideal for buffering units or transit warehouses, where incoming and outgoing operations are performed from opposite sides.

When the lane is not completely emptied, FAST relocates the pallets by bringing them closer to the exit position, allowing new loads to be placed on the rack.

Depending on the required functions, AR SHUTTLE will be equipped with the following elements:

Standard features

- Single Deposit
- Auto Deposit
- Single Retrieve
- Auto Retrieve
- Auto Retrieve by quantity
- LIFO Shuttle
- FIFO Shuttle
- Stock counter

Standard equipment

- On board lithium battery
- Battery charger
- Remote control + charger
- User manual

Optional equipment

- Multi pallets
- Spare parts
- Freezer version



AR SHUTTLE



AR DRIVE IN



AR LS



AR MULTITIER

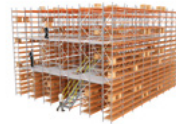

AR UNITLOAD RACK



AR MOBILE



AR LIVE STORAGE



AR SILO CLAD RACK

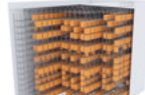

AR PAL



AR MINILOAD RACK



AR RACKING

T +44 (0) 1753 396 924

f in X G

AR Racking UK

The Switch, 1 - 7 The Grove
Slough SL1 1QP, Slough, UK
Tel. +44 (0) 1753 396 924
www.ar-racking.co.uk

Head Office & Technological Centre

Parque Tecnológico de Bizkaia
Edificio 105 - 1A
48170 Zamudio (Bizkaia) Spain
Tel. +34 944 317 941
Fax +34 944 317 838

Production centre

Pol. Ind. Montes de Cierzo,
Autovía A68, KM 86
31500 Tudela (Navarra) Spain
Tel. +34 948 844 480
Fax +34 948 844 420

AR Racking France

43, rue Jean-Pierre Plicque
77124 Villenoy - Paris
Tel. +33 970 912 967
www.ar-racking.fr

AR Racking Germany

Industriestraße 11
55593 Rüdeshheim
Tel. +49 67192034253
www.ar-racking.de

AR Racking USA

5960 Fairview Road, Suite 309
Charlotte. North Carolina 28210
www.ar-racking.us

AR Racking Chile

Av. Pdte. Eduardo Frei Montalva 6199,
Oficina 5010
Conchalí
Tel. +56 (2) 2993 4003
www.ar-racking.cl

AR Racking Colombia

Km 19 Av. Troncal de Occidente
vía Mosquera-Madrid, Bod. 50
Parque Industrial San Jorge
Mosquera, Colombia
Tel. +(571) 8939837
+(57) 3123785226
www.ar-racking.co

AR Racking Peru

Av. Las Camelias 790, Oficina 504
San Isidro, Lima - Perú
Tel. +51 1 680 6625
www.ar-racking.pe